



LICHEN BUILDERS & DEVELOPERS (P) LTD.

KNA Plaza, Kundannur, Maradu PO
Ernakulam 682 304, P 0484 2705596

E lichenbuilders@gmail.com

W www.lichenbuilders.com



MALAPPURAM
A GEM ATOP THE HILLS



LAND OF THE GOOD OMEN

Back in the day, the development of a town depended on its water source. Proximity, size and accessibility were some of the factors for success. It's a good sign that Malappuram is enriched by the Chaliyar, Kadalundi and the Bharathapuzha rivers- there is enough for everyone and more.



LAND OF ANCIENT KNOWLEDGE

Malappuram is a centre for Hindu Vedic learning and Islamic philosophy. Known for their festivals, Malappuram house various mosques, temples and churches that have made numerous contributions to the cultural heritage of Kerala. Like the Kottakkal pooram, celebrated at the renowned Kottakal ayurvedic treatment centre, part of the Malappuram Metropolitan area.



P. Sadanandan Nair

LAND OF THE HISTORY

Anand Arcade is a part of Kerala's rich movie legacy. The predecessor of Anand Arcade, Anand Cine Palace played a huge role in the filmmaking industry. Anand theatre created by the late P. Sadanandan Nair in 1985 pioneered in the Cinema Exhibition Industry, hosting famed directors like Adoor Gopalakrishnan and actresses like Shabana Azmi. Anand Arcade is designed not only to quench Malappuram's thirst for a cultural hub but also to bring the global market to its people.



LAND OF THE GROWTH

Enlisted in the top 10 of the world's fastest-growing cities, Malappuram is gaining the attention of the world. Economists believe that people and investments are shifting from big Metro cities to Urban cities like Malappuram. Quickly becoming a phenomenon, Malappuram looks like the perfect place to invest in- start right from the ground up.



LAND OF THE CONNECTED

Urban cities are the future, for they are strategically located.

Malappuram's location allows its inhabitants to enjoy the facilities of a tier 2 city like Kozhikode. Like the Kozhikode

International Airport, which is technically part of the Malappuram district and is closer to Malappuram than it is to Kozhikode. Not only that Malappuram also has one of Kerala's

busiest ports, the Ponnani Port.



LAND OF THE REFRESHED

Life sometimes gets too much, amidst the growth and development one needs the chance to slow down and catch one's breath. Malappuram's strategic location puts its citizens right next to the Ponnani beach for a little sea breeze and relaxation. Want to make things cool? Head over to the hillside, all the way to Adyanpara waterfalls to unwind and rejuvenate. The best of both worlds, just a short drive away.



LAND OF THE CULTURALLY DIVERSE

Located in the heart of Malappuram city, Anand Arcade is the centre of city life, built to cater to a diverse community and provide a premium shopping experience to all. A happening establishment where it's always fun and exciting for people of all ages and background.





LAND OF THE FASHIONABLE

Aspiring to bring diverse global brands to the people of Malappuram, Anand Arcade hopes to bring a new dimension to shopping in the region. Built at the centre of the city, Anand Arcade makes it convenient for everyone to shop, helping many explore and discover, new and exciting trends of the globe. Bringing the world closer to Malappuram.





LAND OF THE LIVELY

Anand Arcade is made to be a symbol of growth. Bringing in business from around the globe, providing "tier 1 city" facilities like centralised air-conditioning for common areas, premium interiors, and easy to access parking spaces. Setting the benchmark for a classy and comfortable shopping experience that you can't get enough of.





LAND OF THE PARTNERSHIP

Anand Arcade is the collaboration of Anand Cine Palace and Lichen Builders & Developers. Combining the passion of the late P. Sadanandan Nair and the vision of his sons, Sri Krishnanandan and S.N Rajendran of providing a premium shopping experience for Malappuram - Anand Arcade was born. Our experience with handling such projects makes us the best to take on such an ambitious endeavour.



LICHEN A HEAVENLY FEAST

The brand name Lichen stems from the biblical significance of the word manna. It goes back to Egypt, where the Israelites were suffering under the rule of Pharaoh. The Lord heard the Israelites cry for help and sent Moses to save them. He led them through the desert to the Promised Land, Canaan. In the desert the starving community was blessed with a layer of dew around the camp. When the dew was gone, thin flakes like frost appeared on the desert floor. The flakes were called Manna, the feast prepared by the God almighty for his chosen people. Manna tasted different for different people and satisfied the nutritional requirements of various age groups and produced no waste. It fell near the people with faith and far from those who were doubtful.

Later on, the plant Lichen was found to be similar to manna, due to its special qualities. Lichens are known to grow in some of the most extreme environments on Earth—arctic tundra, hot deserts, rocky coasts, and toxic heaps. Lichens are widespread and long-lived. Moreover they survive symbiotically, where both the partner and the host benefit equally.

The brand name Lichen Builders owes its origin to such constructive traits of the plant Lichen. The group's concept of infrastructure development corresponds to that of the Manna, which is the symbol of happiness and heaven and Lichen which offers equal benefits for everyone involved. With infrastructure ideas that are a favourite among all their customers, Lichen Builders have always strived to keep up to the name they have chosen.

As the manna, be sure to hold on to what Lichen Builders have to offer with all its benefits. Lichen Builders has been proving their quality of work and gaining the trust and satisfaction of its investors for the last 25 years reiterating the significance of the brand name.

Lichen Builders invites you to be part of this heavenly feast.



LOWER GROUND FLOOR

A1	2960 sq.ft.	A7	120 sq.ft.
A2	1185 sq.ft.	A8	630 sq.ft.
A3	1100 sq.ft.	A9	580 sq.ft.
A4	1585 sq.ft.	A10	645 sq.ft.
A5	685 sq.ft.	A11	1055 sq.ft.
A6	310 sq.ft.		

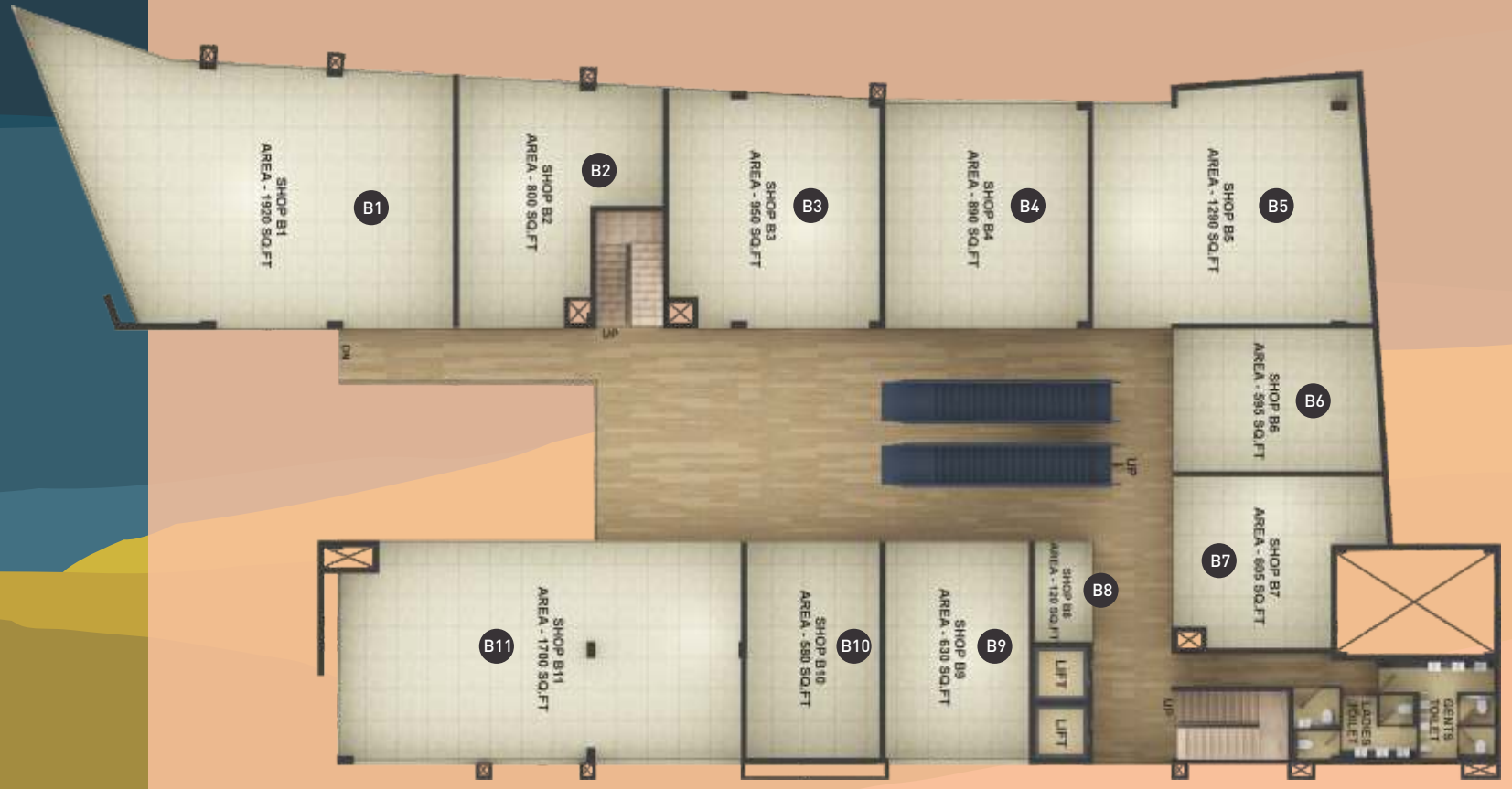

UPPER GROUND FLOOR

B1	1920 sq.ft.	B7	605 sq.ft.
B2	800 sq.ft.	B8	120 sq.ft.
B3	950 sq.ft.	B9	630 sq.ft.
B4	890 sq.ft.	B10	580 sq.ft.
B5	1290 sq.ft.	B11	1700 sq.ft.
B6	595 sq.ft.		

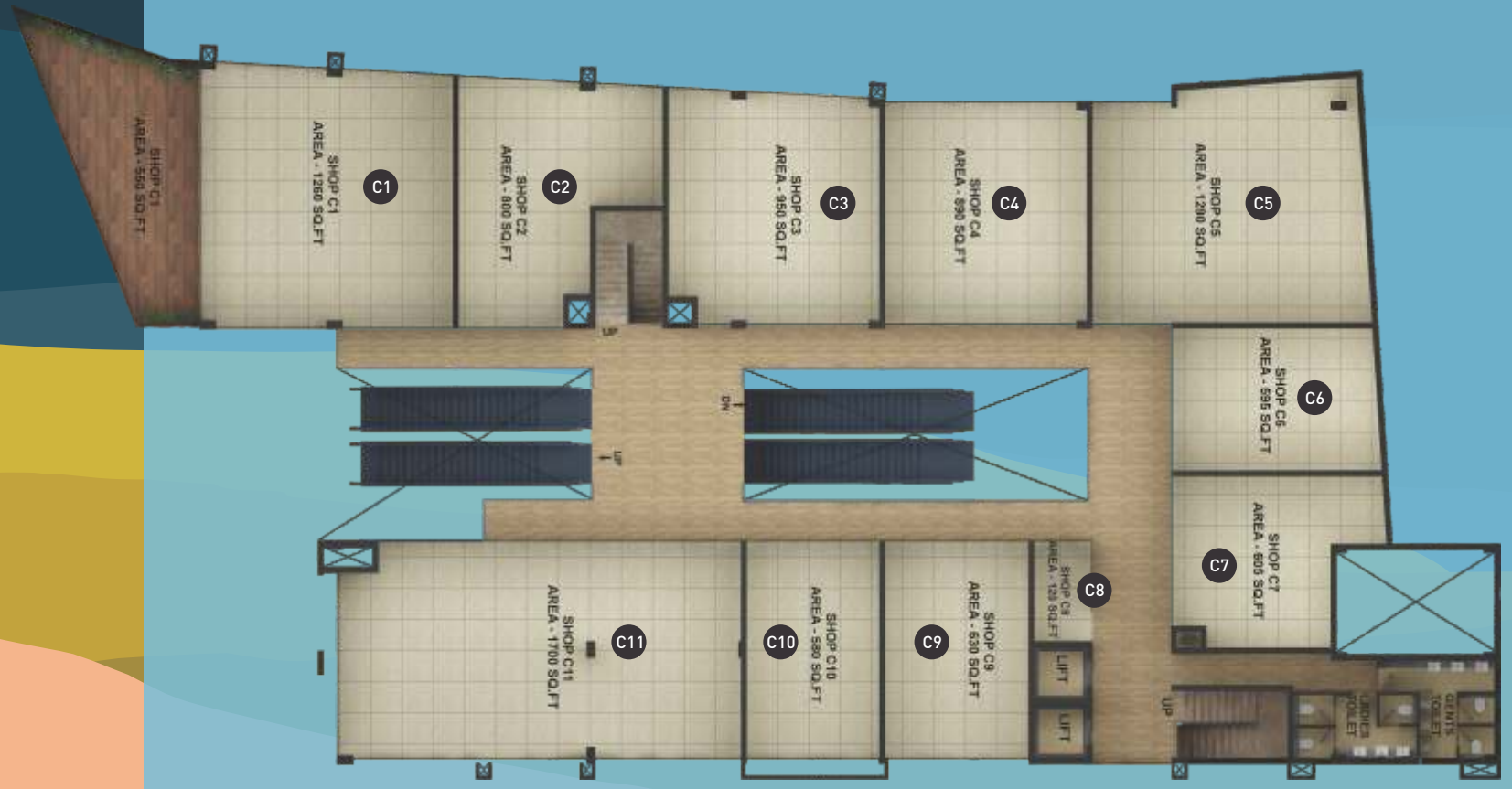

FIRST FLOOR

C1	1260	sq.ft.	C7	605	sq.ft.
C2	800	sq.ft.	C8	120	sq.ft.
C3	950	sq.ft.	C9	630	sq.ft.
C4	890	sq.ft.	C10	580	sq.ft.
C5	1290	sq.ft.	C11	1700	sq.ft.
C6	595	sq.ft.			



SECOND FLOOR

D1	1765	sq.ft.	D7	605	sq.ft.
D2	1365	sq.ft.	D8	120	sq.ft.
D3	950	sq.ft.	D9	630	sq.ft.
D4	890	sq.ft.	D10	580	sq.ft.
D5	1290	sq.ft.	D11	1700	sq.ft.
D6	595	sq.ft.			



BASEMENT FLOOR



TERRECE FLOOR

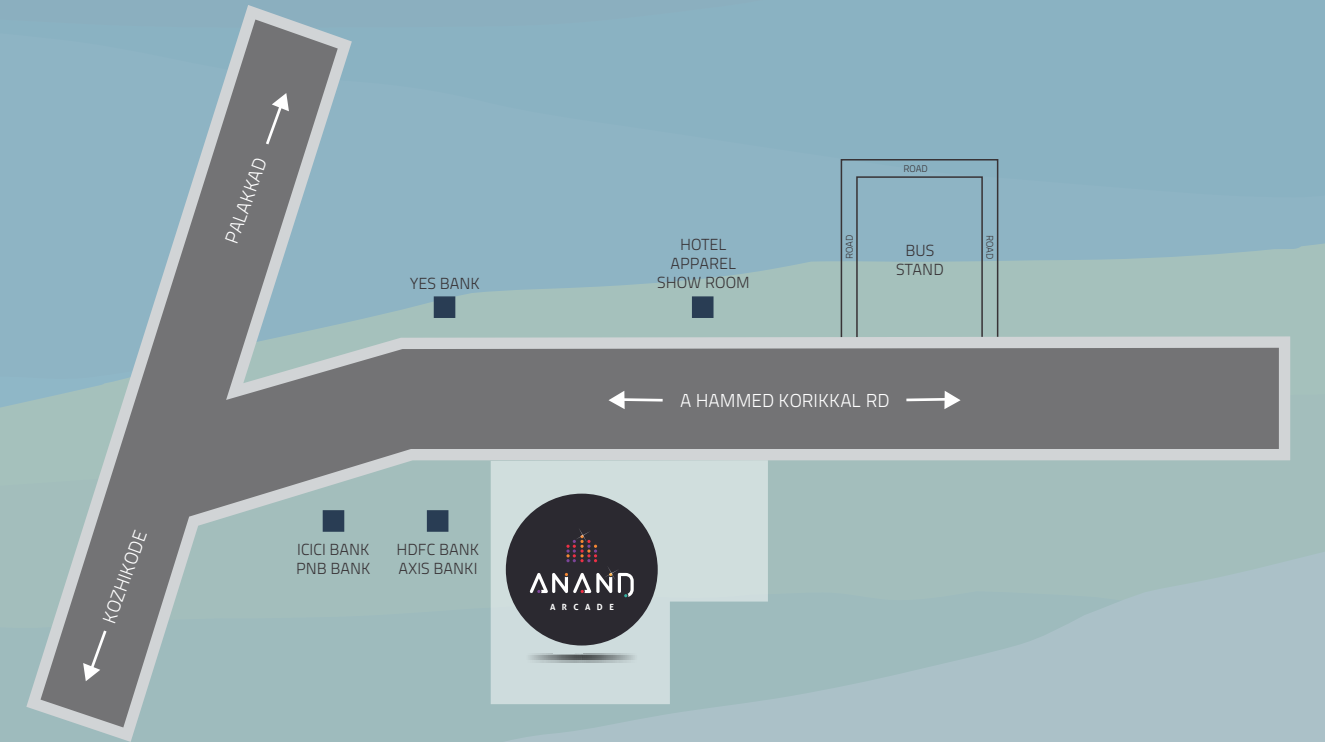

LOCATION MAP

OPENING SHORTLY



K Mall, Thripunithura
The Vision



City Mall, Thalassery.
The Vision

ONGOING



N Square, Thripunithura,
The Vision

VISION



Keloth Square, Kuttiady
The Vision

COMPLETED PROJECTS



V. E. Arcade, Cochin.
Actual Project



Painuthura Towers, Cochin.
Actual Project



Tee Cee Commerce Gate, Thodupuzha.
Actual Project



Joseph Arcade, Pala.
Actual Project



Daliya Plaza, Koilandy.
Actual Project



Yamuna Arcade, Calicut.
Actual Project



Mangalam North End, Thodupuzha.
Actual Project



Rahamania Arcade, Chavakkad.
The Vision



Daliya Square, Vadakara.
Actual Project



Daliya Arcade, Thalassery.
Actual Project



KNA Plaza, Kundannur, Cochin.
Actual Project



Saaff Arcade, Koilandy.
Actual Project