



LICHEN BUILDERS & DEVELOPERS (P) LTD.

KNA Plaza, Kundannur, Maradu PO
Ernakulam 682 304, **P** 0484 2705596

E lichenbuilders@gmail.com

W www.lichenbuilders.com

Developer: Lichen Builders. This brochure does not form part of a legal offer. Information contained in this brochure is subject to change without notice. Slight variations on floor-wise area may occur.

THALASSERY A HIDDEN GEM





Situated by the shores of the Arabian Sea,
on the beautiful Malabar Coast, lies
Thalassery, a city which has played a
significant historical, cultural, educational
and commercial role in the history of India.



With a powerful history and a bright and
promising future, Thalassery is one of the
cities in Kerala that has a huge potential
for aggressive growth.



THE PARIS OF KERALA

Thalassery - 'The Paris of Kerala', a major French military base in Kerala in the nineteenth century. Thalassery is also known as the city of cakes, cricket and circus. The first cake ever made in India was baked in Thalassery's Royal Biscuit Factory in 1883. Cricket came to Thalassery in the 1800's. The city is also considered to be the birthplace of Indian circus.





THE SPICE CAPITAL

Thanks to its strategic location and high quality merchandise, Thalassery has a long history of being a spice hub, with trade flourishing with Europe, China and the Middle East. Many a war has been fought over the control for Thalassery's lucrative spice markets. Even now it is well known for its home grown variety of black pepper (Thalassery pepper), and is also a major trade centre for cardamom, cinnamon, coffee and nutmeg.





THE ROYAL LEGACY

The royal history of Thalassery dates back to centuries, with the Zamorin, Tipu Sultan and Pazhassi Raja all waging conquests in the area. Foreign agents also played a huge role in the military history of Thalassery. The Thalassery Fort and its battlements are a reminder of years of conflict between the French, Dutch, Portuguese and British naval forces.

A close-up photograph of a bowl of Thalassery biriyani. The dish consists of long-grained, saffron-colored rice mixed with tender, dark brown meat pieces. A fresh green mint leaf is placed on top as a garnish. The bowl is made of polished metal and sits on a wooden stand. In the background, a large brass pot is visible, and the scene is lit with warm, natural light from a window.

THE PRIDE OF MALABAR

The spirit of Malabar lives on in every corner at Thalassery, with its delectable cuisine and warm, friendly people. In fact, the Thalassery biriyani has gained a legendary status in Indian cuisine. With a population just under 100,000, it is the largest populated municipality of North Malabar.



THE URBAN MAKEOVER

Modern Thalassery is a bustling township and one of the commercial hubs of North Malabar. It is well connected and well developed, and is the 8th largest city in Kerala. Thalassery is home to a significant NRI population, and the economy is dependent on expatriates. Thalassery also attracts many tourists with Muzhappilangad beach, Dharmadam beach and the Thalassery Pier some of the main attractions.





THE MODERN MARVEL

Adding to the ever expanding urban skyline of Thalassery is City Mall, an all new shopping mall jointly developed by Lichen Builders and JAAS Developers. Located at OV Road, City Mall is all set to redefine the shopping experience in Thalassery.





THE APEX OF CONVENIENCE

Equipped with state of the art escalators and car lifts along with two floors of car parking, shopping at City Mall will be as convenient as it gets. Our projects are specially designed to allow quick and easy access.





THE SPATIAL EXTRAVAGANZA

Spread over 40,000 sq. ft area, City Mall will house a wide variety of shops and establishments, with shop spaces of 150 sq. ft and above available for use. Supermarkets, lifestyle brands and eateries will all be a part of the City Mall experience.

COME DOWN
TO EARTH
The ground floor view.



FEAST ON!

Relish and indulge in our varied cuisines from everywhere around the globe, right here at City Mall, Thalassery. The food court, spread over an entire floor, offers a treat for your palette. Choose from your favourites and dig in to an exciting range of sumptuous food choices, perfect for when you're out with friends and family!



FOOD COURT
So much to choose from!



INDULGE IN SOME FUN

City Mall at Thalassery hosts a variety of entertainment platforms - the kid's play area being one among them. Aiming at delivering a full fledged family oriented spot for shopping and some fun, our games section is bound to keep even the children active and well-cared for at all times.



PLAY AREA
Just play, play and play!



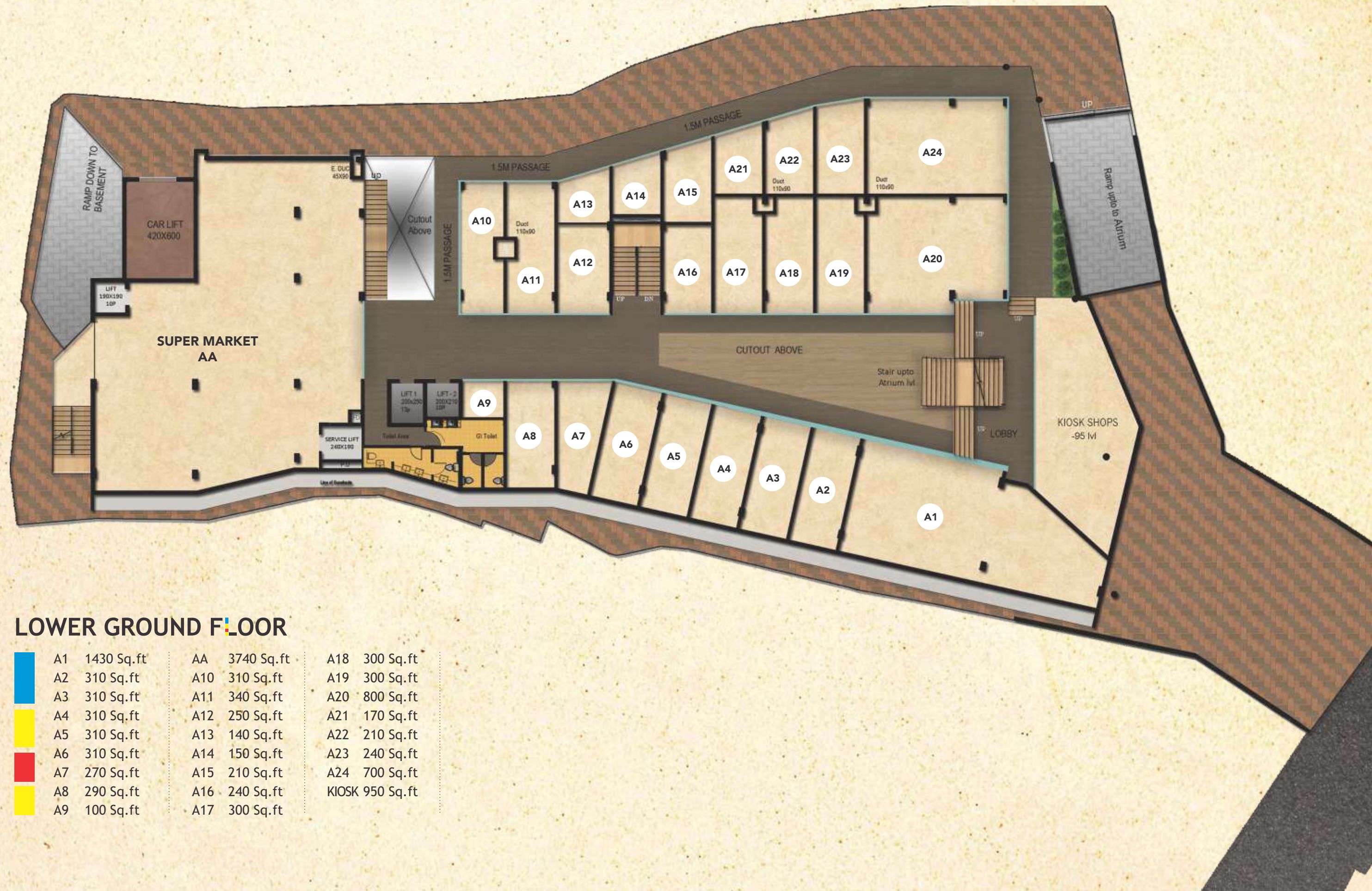

LOWER GROUND FLOOR

A1	1430 Sq.ft	AA	3740 Sq.ft	A18	300 Sq.ft
A2	310 Sq.ft	A10	310 Sq.ft	A19	300 Sq.ft
A3	310 Sq.ft	A11	340 Sq.ft	A20	800 Sq.ft
A4	310 Sq.ft	A12	250 Sq.ft	A21	170 Sq.ft
A5	310 Sq.ft	A13	140 Sq.ft	A22	210 Sq.ft
A6	310 Sq.ft	A14	150 Sq.ft	A23	240 Sq.ft
A7	270 Sq.ft	A15	210 Sq.ft	A24	700 Sq.ft
A8	290 Sq.ft	A16	240 Sq.ft	KIOSK	950 Sq.ft
A9	100 Sq.ft	A17	300 Sq.ft		

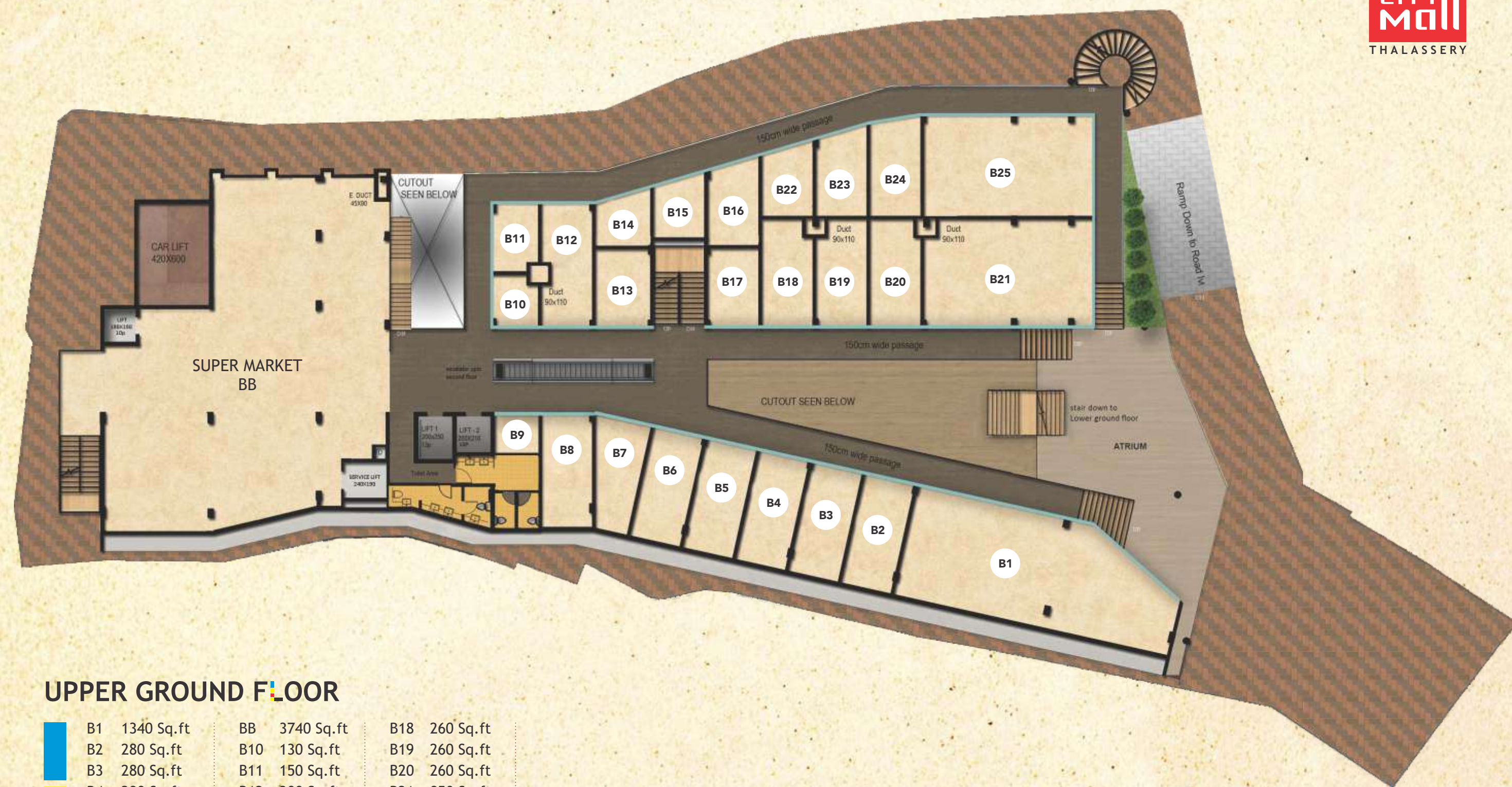

UPPER GROUND FLOOR

B1	1340 Sq.ft	BB	3740 Sq.ft	B18	260 Sq.ft
B2	280 Sq.ft	B10	130 Sq.ft	B19	260 Sq.ft
B3	280 Sq.ft	B11	150 Sq.ft	B20	260 Sq.ft
B4	280 Sq.ft	B12	300 Sq.ft	B21	850 Sq.ft
B5	280 Sq.ft	B13	220 Sq.ft	B22	180 Sq.ft
B6	280 Sq.ft	B14	140 Sq.ft	B23	200 Sq.ft
B7	250 Sq.ft	B15	150 Sq.ft	B24	240 Sq.ft
B8	290 Sq.ft	B16	210 Sq.ft	B25	790 Sq.ft
B9	100 Sq.ft	B17	200 Sq.ft		

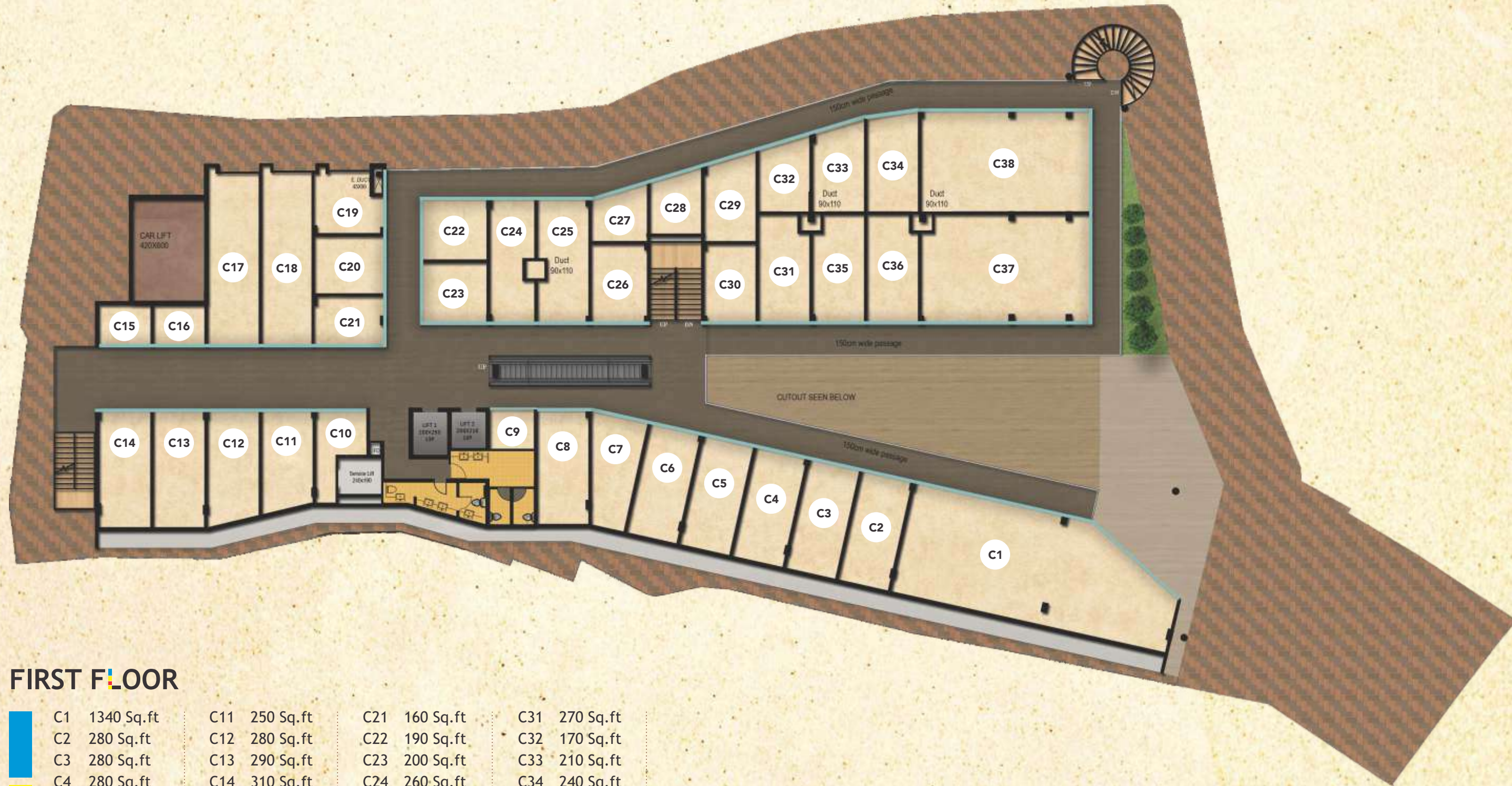

FIRST FLOOR

C1	1340 Sq.ft	C11	250 Sq.ft	C21	160 Sq.ft	C31	270 Sq.ft
C2	280 Sq.ft	C12	280 Sq.ft	C22	190 Sq.ft	C32	170 Sq.ft
C3	280 Sq.ft	C13	290 Sq.ft	C23	200 Sq.ft	C33	210 Sq.ft
C4	280 Sq.ft	C14	310 Sq.ft	C24	260 Sq.ft	C34	240 Sq.ft
C5	280 Sq.ft	C15	120 Sq.ft	C25	300 Sq.ft	C35	270 Sq.ft
C6	280 Sq.ft	C16	110 Sq.ft	C26	220 Sq.ft	C36	270 Sq.ft
C7	250 Sq.ft	C17	450 Sq.ft	C27	140 Sq.ft	C37	850 Sq.ft
C8	280 Sq.ft	C18	410 Sq.ft	C28	150 Sq.ft	C38	790 Sq.ft
C9	100 Sq.ft	C19	220 Sq.ft	C29	210 Sq.ft		
C10	190 Sq.ft	C20	210 Sq.ft	C30	200 Sq.ft		



SECOND FLOOR

AMUSEMENT AREA	5215 Sq.ft
FOOD COURT	10265 Sq.ft

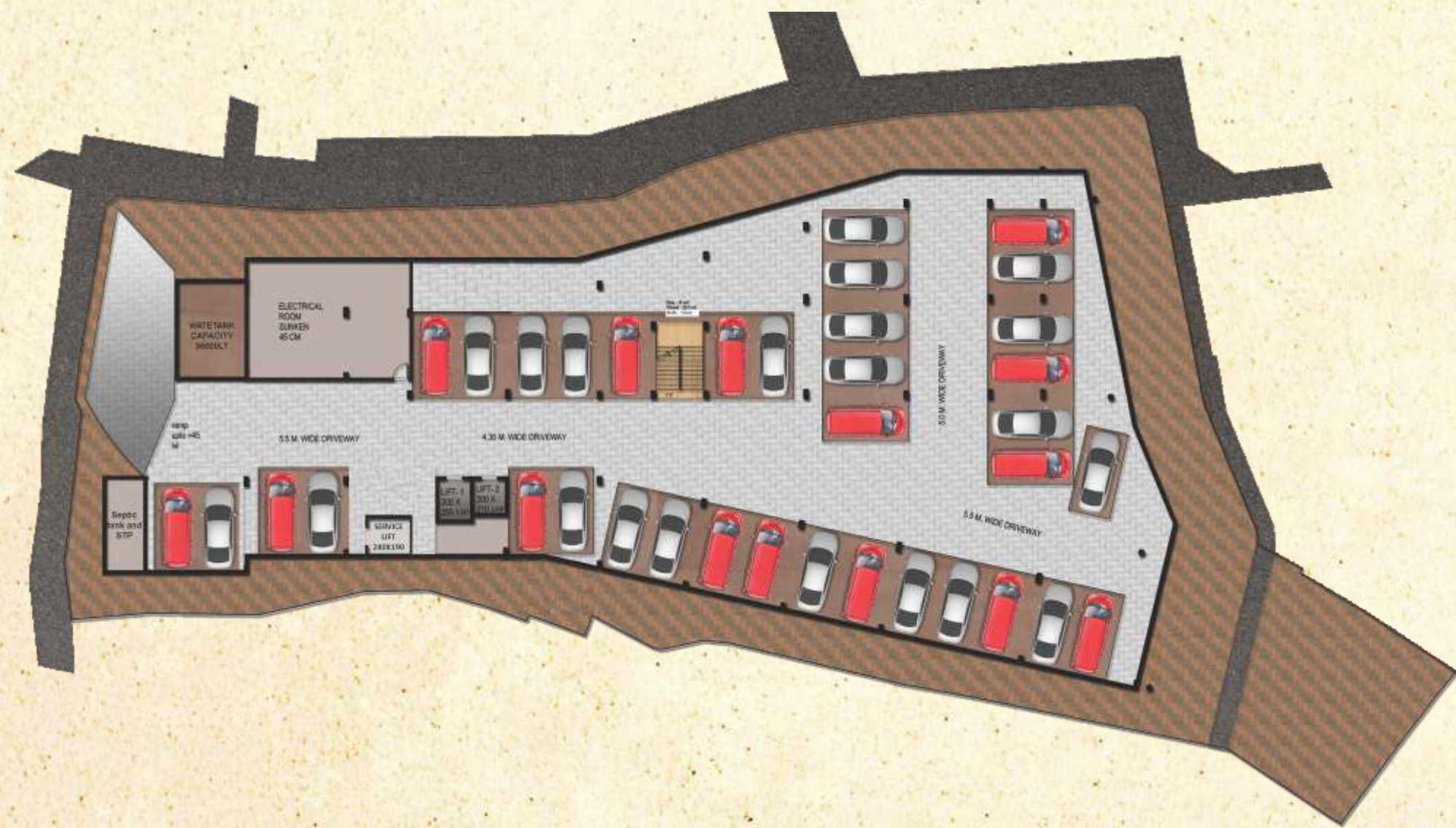

BASEMENT FLOOR



TERRACE FLOOR

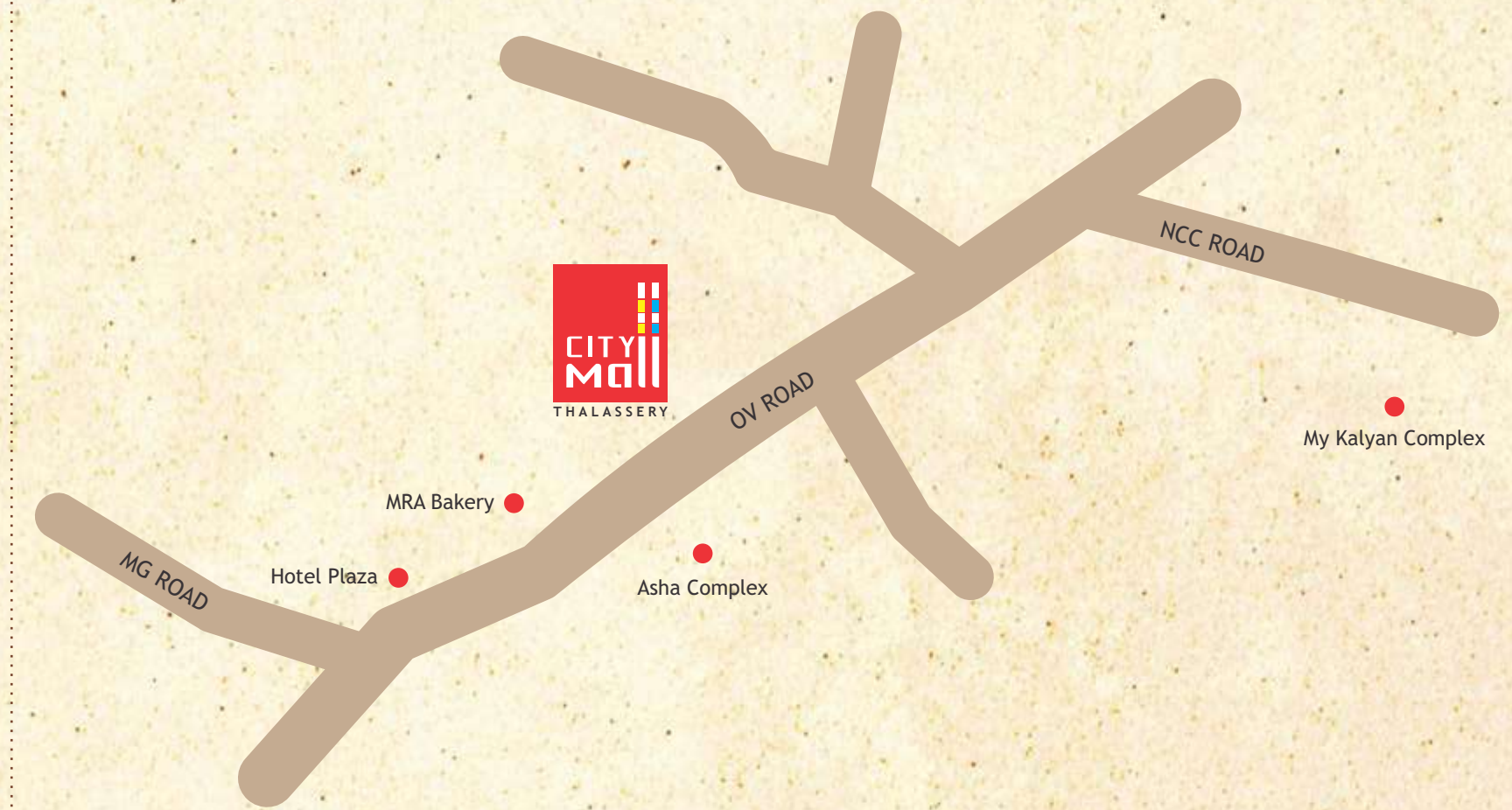

LOCATION MAP





THE SECOND COMING

City Mall is Lichen's second project in Thalassery, after Daliya Arcade. After the success of Daliya Arcade, City Mall is yet another ambitious project which Thalassery can proudly flaunt.



OUR PARTNERS

Lichen collaborated with the reputed firm JAAS Developers for our project, City Mall. Bringing in tomes of experience, JAAS Developers is represented by some of the celebrated names in the North Malabar and the Gulf.



Jawad Ahmed

A proud owner of businesses across the Gulf and North Kerala, he runs the Al Madina Trading, UAE, Foodworld Group of Companies - Qatar, Family Mart Supermarket, Thalassery, P.K. Tools, Thalassery, Mahe & Ernakulam and Metro Furniture, Kuthuparamba.



R P Abdul Rahiman

Having spent years across the borders in Saudi Arabia and Dubai, another of our partners playing a key role in this project, his business is spread across the Middle East in Saudi, including the Royal Gift Shop, Khamis Mushayit, City Center, Khamis Mushayit and Option, Khamis Mushayit; whereas in Dubai, he runs the Highlander Restaurant, Madeena Mall, Big Bazaar Hypermarket, Sharjah and the Jabal al Thalj Restaurant.



Saidulli

A successful entrepreneur in the North Malabar, his popularity in the region was by no means a small feat in bringing notice to our project at hand. An ace at closing deals, his master stroke moves leave you in awe, making him one of the sought after realty experts in and around that region.



LICHEN-A HEAVENLY FEAST

The brand name Lichen stems from the biblical significance of the word manna. It goes back to Egypt, where the Israelites were suffering under the rule of Pharaoh. The Lord heard the Israelites cry for help and sent Moses to save them. He led them through the desert to the Promised Land, Canaan. In the desert the starving community was blessed with a layer of dew around the camp. When the dew was gone, thin flakes like frost appeared on the desert floor. The flakes were called Manna, the feast prepared by the God almighty for his chosen people. Manna tasted different for different people and satisfied the nutritional requirements of various age groups and produced no waste. It fell near the people with faith and far from those who were doubtful.

Later on, the plant Lichen was found to be similar to manna, due to its special qualities. Lichens are known to grow in some of the most extreme environments on Earth—arctic tundra, hot deserts, rocky coasts, and toxic heaps. Lichens are widespread and long-lived. Moreover they survive symbiotically, where both the partner and the host benefit equally.

The brand name Lichen Builders owes its origin to such constructive traits of the plant Lichen. The group's concept of infrastructure development corresponds to that of the Manna, which is the symbol of happiness and heaven and Lichen which offers equal benefits for everyone involved. With infrastructure ideas that are a favourite among all their customers, Lichen Builders have always strived to keep up to the name they have chosen.

As the manna, be sure to hold on to what Lichen Builders have to offer with all its benefits. Lichen Builders has been proving their quality of work and gaining the trust and satisfaction of its investors for the last 25 years reiterating the significance of the brand name.

Lichen Builders invites you to be part of this heavenly feast.

ON GOING LICHEN PROJECTS



Daliya Square, Vadakara.
The Vision



Daliya Arcade, Thalassery.
The Vision



K Mall, Thrissur.
The Vision



KNA Plaza, Kundannur, Cochin.
The Vision



Saaff Arcade, Kollam.
The Vision



Adoor Heights, Luxury Apartment,
Adoor. The Vision

COMPLETED LICHEN PROJECTS



V. E. Arcade, Cochin.
Actual Project



Painuthura Towers, Cochin.
Actual Project



Tee Cee Commerce Gate, Thodupuzha.
Actual Project



Joseph Arcade, Pala.
Actual Project



Daliya Plaza, Kollam.
Actual Project



Yamuna Arcade, Calicut.
Actual Project



Mangalam North End, Thodupuzha.
Actual Project



Rahamania Arcade, Chavakkad.
The Vision